

B01 Arquitectes

Profile of an architecture office

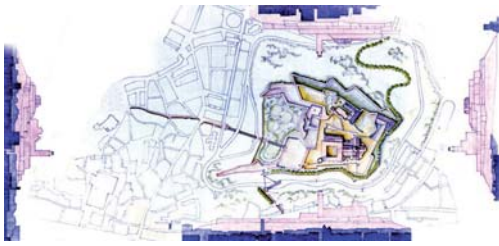

The family company, Amadó-Domenech Arquitectes, reaffirms its professional career at the beginning of the 80s in Lleida by participating in the team which wins the Historic Centre Plan competition. The couple of Roser Amadó and Lluís Domenech with the collaboration of Ramon Domenech (surveyor) saw to develop the main projects of this Plan (wall, lift, park, school and court) in an intervention which receives the National Urban Award in 1986 and is published in diverse books and magazines. Domenech brothers come from a tradition begun by the architect Lluís Domenech I Montaner, the great architect, politician, archaeologist and modern heraldry of the Catalan Modernism. With Antonio Gaudí, Domenech I Montaner completes the list of 9 World Heritage Site buildings in Barcelona.



Lluís Domenech Girbau, his great-grandson, has studied the work of his predecessor in different books and the Amadó-Domenech team took part in 1979 in the restoration of Domenech House in Canet de Mar, in the Master Plan of Sant Pau's Hospital y later, in 1985-90, in one of the most important works in the modernist field, the Montaner Simon Publishing House, which is the first building joining industry with offices in the *Eixample*. The great intervention of Amadó and Domenech for turning the construction into the Tapies Foundation deserves, among other distinctions, the Decada Award given by a jury composed by Robert Venturi and Denise Scott-Brown.



At the beginning of the 70s, Roser Amadó manages the *Nuevo Ambiente* magazine and Lluís Domenech takes part in the editorial board of *Arquitectura bis* with Oriol Bohigas, Manuel Sola-Morales y Rafa Moneo; this fact allows them to gain a critical basis. In another period Lluís Domenech is appointed commissioner for the Picasso's Year (1981-1982) and later was in charge for the Museums Plan for the Barcelona City Council, approved in 1985 and developed until nowadays. He has also taken part into the Art Museums Board until 2009.

With this background, the Amadó Domenech company receives several jobs: *Paseo Picasso* (1981), House in Comtal Street (1984 Construmat Award), Police Headquarters (in collaboration with D.F.Javier Sáenz de Oiza, 1985), and won the Central Laboratory competition for the *Govern of Catalunya* (1983).



The Olympic years contributed with a building in the Olympic Vila and the construction of the new building for the Aragon Crown Archives and rehabilitation of the old headquarters, the *Virreyes Palace* which was one of the marks of the team in the restoration field where they collaborate with restores from the MNAC and archaeologist from the *Generalitat*. From this period, it is the *Carburos Metalicos* headquarters in Aragon Street, which is a paradigm of the adaptation to the *Eixample's* morphology. It was designed also the Arcediano House, which complements the interventions in the Ghotic district. As a result of this work, the *Gustavo Gili* Publishing House publishes "*Dos patis mediterranis*" (2006).



In the post-Olympic period Amadó-Domenech continue with the same interesting job and participate in diverse competitions in Agadir (Morocco), Girona, Madrid and Malaga (with Siza Vieira y V.Gregotti). It is won the design for the new Law Faculty in Lleida, selected work for the Venice Biennial Exhibition (2004).

The turn of the century meant a great transformation in the professional study which incorporates three partners: Sander Conelius Laudy, Dutchman from the TU Delft; Carles Cortadas who realices a posgraduate degree in Milan and Paris on car design and Laura Pérez, interiorist from the Eina School in Barcelona and computer expert. The study is named B01 Arquitectes, founds a new office and incorporates also an administrator and a fiscal consultant, combining closeness to people and professional efficacy.



The new professional structure has worked deeply in the housing field, both public (Building at Marina Street PMH) and private (Colonial, Urbis, Matrovacesa, Salas Serveis Inmobiliaris, etc) as well as dormitories (Torregirona, U.P.C.).

The vocation of Roser Amadó (master MAUS 1998 E.T.S.A.B.), Sander Laudy and Ramón Domenech in the sustainability field has reinforced the ideological and technological background of B01 (Competitions in Teruel, Cairo and Ebro Delta). This characteristic has marked significantly the last work, from the ones of great territorial and technological impact (the new Technological Center Leitat Terrassa inaugurated in 2010), the relation with urban structures (competition won for the "*Casco Vello*" in Vigo) or the ones which have the respect to the natural environment as purpose scarcely intervening in the construction (Llobregat Delta – Carrabiners Barracks, 2009).



In this works B01 has collaborated with, over the essential BOMA structure consulting, with engineers specialized in energetic saving and alternative energy (Aiguasol, PGI, Einesa, Alex Ivancic) and recently the contribution of the physicist Higiní Arau has been decisive to design acoustically Sant Andreu and Lloret theatres, finished in 2010.

Human Resources

Team Leaders

SENIORS

Roser Amadó Cercós, *architect*

Lluís Domènech Girbau, *doctor architect*

Ramon Domènech Girbau, *technical architect*.

JUNIORS

Sander Cornelius Laudy, *architect*.

Carles Cortadas Guasch, *architect*

Laura Pérez García, *interior designer*.

Coworkers

Cristina Subias Soto, *technical architect*

Miquel Angel Pozo, *technical architect*.

Federico Calabrese, *architect*. B01
representative in Brasil

Isabel Pérez, *architect*.

Mònica Olivé, *administration*.

David Millans, *accountant*.

External Coworkers

Structural Engineering Consultancy: BOMA, *Arquitectes Associats*.
(www.boma.es)

Topography: Eduardo Alonso, *Professor in Soil Mechanics*.

Environment: Alex Ivancic, *Industrial Engineer*; Actea, *Gestió Ambiental*, S.L.

Installations: PGI (www.pgigrup.net); TCA (Fumadó-Briz, *arqtes. Barcelona*); Einesa (Lleida) (www.einesa.com); Armengol Enginyers (www.aenginyers.com).

Transport Engineering: Ineco (www.ineco.es)

Landscaping and Gardening: Matèria verda (www.materiaverda.com)

Acoustics: Higiní Arau. *Doctor in Architectural Acoustics*.
(www.arauacustica.com)

Psychosocial Research: Spora (www.spora.ws/cat)

Consulting firm specializing in international development: Ibergeo
(www.iber-geo.com)

Rehabilitation Techniques: J. Villanueva, *enginyer*. Sapic (www.sapic.es)

Legal Advisory: A.Jaumandreu (Roca Junyent, *Advocats Associats*).

Graphic Design: Joana Santamans, Ivan Caño, Inercia (www.inerciabcn.com)

Renders (3d and video): Play-Time (Marc Albiol) (www.play-time.es)

Curriculum Vitae

Lluís Domènech Girbau

Born in Barcelona 2nd November 1942.

Qualified as an architect in 1964 from ETSA (Higher Technical School of Architecture), Barcelona. (Specialized in Urban Planning)
Doctorate from ETSA, Barcelona with a thesis on the *Arquitectura de los años 40 en España* [Architecture of the 1940s in Spain].
Associate with R. Puig and L. Sabater until 1974. Professionally working with Roser Amadó since 1974.

B01 Arquitectes S.C.P. was constituted in 2001.

- Lecturer on Architectural Composition in ETSA (Higher Technical School of Architecture) Barcelona, 1965.
- Lecturer on the doctorate course *La Periferia* [The Periphery] with M. Solà-Morales, 1993
- Lecturer on a Domènech i Montaner course in Barcelona School of Architecture, 1995-96.
- Lecturer on doctorate course in San Sebastián School of Architecture, 1988.
- Lecturer on UIMP (International University Menendez Pelayo): Seville, 1987; Cuenca, 1988; and Complutense University, 1993.
- Speaker in seminars and congresses for the Official Institute of Architects: Cantabria 1986, Zaragoza 1988, Granada 1990, Pamplona 1991.
- Lecturer on *Intervención en el Patrimonio* [Intervention in Heritage] course, Institute of Architects of Catalonia, 1990.
- Catalan delegate to the congress *Europe des Architectes*. Paris 1991.
- Lecturer on Museology courses, Ministry of Culture: Madrid'92, Mérida'92.
- Member of the commission for Culture of the COAC.Barcelona.1965-70
- Member of the commission for the industrial heritage of Poblenou, Barcelona.
- Member of the Domènech i Montaner Foundation (2006-2007).
- Chief Commissioner of the MNAC, National Museum of Catalanian Art.(1986-2006)

Roser Amadó Cercós

Born in Barcelona 22nd January 1944.

Qualified as an architect in 1968 from ETSA (Higher Technical School of Architecture), Barcelona. (Specialized in Urban Planning).
Master in Urban Environment and Sustainability in UPC (Polytechnic University of Catalonia), 1998.

LIFE programme course: Sert School, Institute of Architects, 1998.
Professional associate of Lluís Domènech since 1974.

- Technical Workshops on Energy Saving, UED, November 1997
- Editor of the journal *Nuevo Ambiente*, 1970.
- Speaker on Contemporary Spanish Architecture seminar from Institute of Architects, Santander, 1986.
- Lecturer on UIMP (International University Menendez Pelayo) Cuenca, 1988.
- Lecturer on Intervention in Heritage course from Institute of Architecture of Catalonia, 1990.
- Lecturer on International University Menendez Pelayo, Santander, 1991.
- Lecturer on Complutense University, El Escorial, 1993.
- Member of the Commission for the Cultural Heritage of Catalonia, Generalitat, 1994-98.
- Lecturer on 15th Summer School, Alcalá de Henares, 1998.
- Exhibition and catalogue *Arquitectura para después de una guerra* [Architecture for After a War], 1978.
- Domènech i Montaner exhibition, Milan, 1979-80.
- Speaker on the *Vivienda pública en Barcelona* [Public housing in Barcelona] Conference, 1990-2005
- Coworker in the *Vivienda pública en Barcelona* [Public housing in Barcelona] book for the Patronat Municipal de l'Habitatge.
- Speaker in the *Technical conference: accessibility and architecture in Historical Centres, mechanical solutions*. January 2008.

Curriculum Vitae

Ramon Domènech Girbau

Born in Lleida, the 30th of January 1944.

Interior designer from EINA School of Design, 1970.

Qualified as Technical Architect, 1986.

B01 Arquitectes S.C.P. was constituted in 2001.

· *Diagnosis y tratamiento de la piedra en rehabilitación de edificios* [Treatment and diagnostics of stone masonry in building rehabilitation]. Institute of Technical Architects Workshop, 1997.

· Energy efficiency workshops. UEDG November 1997.

· Technology professor in EINA, School of Design since 1970.

· Professor in *Building Rehabilitation Workshop* at the Technical Architects School in Barcelona, 1990.

· Professor in *Master in Historic Building Rehabilitation* at the Institute of Technical Architects, 1994.

· Author of the book *Instalaciones y materiales* [Installations and Materials] Atrium Publishing, 1990.

· Collaboration in the architecture magazines: *Construir*, *Cercha*, etc.

· Collaboration with R. Amadó, Ll. Domènech and L. Sabater on the building in Sant Feliu de Guixols Apartments included in the *Artistic Building Catalogue of the Girona Province*.

· Collaboration with M. Espinet & A. Ubach in the rehabilitation of the University of Lleida building 1989 and rehabilitation of the Sentmenat Palace in Barcelona, 1993.

· Since 1974 collaborates in association with Amadó & Domènech Architects as construction system designer and construction supervisor.

· Professor and coordinator of the *Diseño de Interiores y Confort ambiental* [Interior Design and Environmental Comfort] Postgraduate at the EINA School of Design UAB, 2001-2002.

· Trustee of EINA Foundation, 1999.

Sander Cornelius Laudy

Born in Amsterdam, the Netherlands, 1st september 1974.

Qualified as an architect in 1999 from TU Delft (Politechnical University Faculty of Architecture) Delft, the Netherlands.

Politechnical University TU Delft, Holland. PFC 1999: Expopoort design. Erasmus en ETSA Barcelona, España, supervised for E. Bru and J. Valor, 1996.

Partnership with B01 arquitectes in 2005.

· Organisation of the international design workshop *Object & Ruimte*, TU Delft 1995

· Collaboration with Big House Architecture, 1997.

· Extension on Private House for Oudhof family, Harfsen, the Netherlands, 1999

· Various publications in daily newspaper *het Parool* and *de Architect*, the Netherlands

· Collaboration with Heren 5 Architecten, Amsterdam, 1999.

· Honorable mention for San Francisco State University Gate Competition 1999

· Participation in the Sunset Park competition, Brooklyn New York, in collaboration with Mr. Thomas Offermans, 2000.

· Teacher on Technology of Interior Design, EINA Superior School of Design, Barcelona, 2002-2008

· Teacher in the Postgrade Course *Interior Design and Environmental Confort*, EINA Superior School of Design, Barcelona, 2004

· Collaborator A10 Magazine, Modern European architecture

· Treasurer of *Construint a la Sala* association, architectural workshop for Children, Barcelona 2007

· Conference at the Master of Landscape in University of Barcelona, 2009

Carles Cortadas Guasch

Born in Barcelona 18th January 1978

Qualified as an architect in 2003 from ETSA (Higher Technical School of Architecture), Barcelona.

ETSA (Higher Technical School of Architecture) PFC 2003: Riding Club in Cerdanya

Master in *Diseño de automoción* [Automobile design] in Scuola Politécnica Design (Milan), 2003-2004.

Partnership with B01 Arquitectes in 2005

· Freelance 3D works for various architectural projects

· Basket coach (Coach A Level), 1999-2002.

· Works with Xefo Guasch architect, Barcelona, 2000-2001

· Collaboration with the Architecture Sport Area, 2000-2001

· Works related with the Circuit de Catalunya, 2001

· Collaboration with B01 Arquitectes. 2001-2003

· Ski instructor, 2001-2002

· Course of 3D and renders (Form Z and Lightwave). 2002

· Design Centre ADN PSA Peugeot-Citroen, Paris 2004-2005 (engaged for Mazel Engineering)

· Course of 3D and renders (3Dstudio and Photoshop), 2007.

Laura Pérez García

Born in Barcelona, 10th of January 1981

Qualified as interior designer from Superior School of Design EINA, Barcelona, 2003.

PFC 2003: Restaurant in Barcelona.

Collegiate numbered 1919 in the Institute of Interior Designers and Decorators of Catalonia CODIC.

Postgrade Course *Diseño interior y confort ambiental* [Interior Design and Environmental Confort] EINA Superior School of Design in Barcelona, 2004

Partnership with B01 Arquitectes in 2005.

· Collaboration with B01 Arquitectes. 2001-2005

· Course of 3D and renders (form-Z and Lightwave). 2002

· Course on textile Architecture, 2002

· Finalist, 6th prize, Final Degree project for interiorism students, Codic, 2004

· Local 214 project, Spabelleza, interior design, Comercial Center Glories, Barcelona 2004

· Technical course on Web design, 2005

· Course ICad, SERT School 2004.

· Course of 3D and renders (3Dstudio and photoshop). 2007

Technical Infrastructure

The office is provided with all the needed equipment to guarantee the development of a proposal:

- Working space for 12-14 people
- Hardware maintenance: We arrange a company which is in charge of the computer maintenance in the office.
- Office material for the project design (bookbinder, hole punchers, paper cutters, paper destroyers,...)
- Accessories and peripherals: cameras, digital scanner, credit card reader, 1TB hard disk.
- In order to satisfy the Data Protection Organic Law (15/1999) a company is contracted for eliminate and reciclate our documents and the office consumables.

Software

OPERATING SYSTEM

-Windows XP Profesional ; Windows 7 Profesional ; Windows Server 2003

MANAGEMENT SYSTEMS

Administration: Microsoft Office 2007 ; Outlook 2007

Project development: SS ; TCQ 2000 ; PRESTO ; Control Q ; Libro del edificio ; OpenOffice v2.3 ; SP Gestió v.4 ; GEST. COLEGIAL v.4; DOCS VISAT v.4 ; LOTUS ORGANIZER v.5 ; SP CONTAPLUS ELITE V2010 ; RELEASE 6

Design - Image: AutoCad 14 ; AutoCad 2000i Map ; AutoCad 2006 LT ; Autocad 2012 LT ; UrbiCad ; iCad v6 ; Corel Draw ; Photoshop CS3 ; 3D Studio ; Adobe Acrobat 8.0 ; Acdsee 8.0 ; AbbyyFine Reader v.6

Hardware

CENTRAL COMPUTER

Network Server: HP Servidor Proliant ML350 G4, Intel Xeon (TM) 3Ghz, RAM 1024Mb, HD 135Gb

PERIPHERAL EQUIPS

Nº: 14 Pc's Dell. Model Precision/Dimension
Intel® Pentium® 4 3Ghz/ 2Gb Ram/ HD 320Gb
Graphic Card nVidia 8600GTX de 256Mb
Ethernet network connection
Reader and writer of DVD / CD
17"-21" panoramic screens

NOTEBOOK COMPUTER

Notebook Hp Pavilion 1,5Ghz; Notebook Dell Vostro 2,8Ghz
Netbook Samsung N130 1,6 Ghz.

NETWORK CONNECTION

Network type: Ethernet; Wiring type: RJ45-Par;
Protocol used: TCP/IP ; Speed: 1Gbps

Available network elements: Switch 3COM OfficeConnect Wireless 11g; Firewall Sonic Wall ; Backup form tape (Back up-HP StorageWorks Ultrium); External HD network; Uninterruptible power supplies (SAI) Model Ellipse Max 1100- MGE, 1 for every 2 computers; 1 Router (ADSL i WIFI); External HD; DVD-RW/CD-RW; 2 HD External via USB; Plotter HPDesingjet 800; Plotter HP DesignJet 110NR; iR 2380/fax/scanner;Hp Laserjet 3005dn; Dell Multifunción

Concrete experience in bioclimatic and environmental architecture

B01 Arquitectes has worked on several projects in recent years where priority has been given to concerns on sustainability and environmentally conscious architecture. The most recent of these projects are:

- 2000. Participation in the international bid for the reconstruction of Sarajevo, Bosnia. Called by the U.I.A. with a energetic efficiency focus.
- 2001. Research Building for the UPC Campus in Castelldefels. Competition finalist in the called by the University Commission. (Use of ventilated facades with energy recuperation, use of ground water for refrigeration of the water heating installations, energy generation by means of photovoltaic energy.)
- 2002. 2nd Prize for Urban Planning of Baronia de Escriche Competition, called by the Diputación de Teruel. Proposal for the total sustainability of the Natural Park. (Autonomous energy production, waste management, water cycles.)

In these projects, the following specialists have collaborated: Alex Ivancic, consulting engineer for the European Union energy efficiency commission. Gerardo Wadel, architect, Director of *Constructiva* Magazine (sustainable constructive elements). ACTEA, Environmental Management.

Our Studio has applied criteria to meet the LIFE Program and has acquired in the last years concrete experience in the subject of this chapter: Improvement of thermal and acoustic insulation, taking advantage of thermal inertia of constructive elements for energy efficiency and as a source of thermal comfort.

Solar energy systems by means of solar panels and silica photovoltaic cells.

Our Studio has taken part in a series of permanent masters programs and workshops as part of our policy:

Treatment and diagnosis of stone building masonry and their rehabilitation. (U.P.C.)

Light Facades, the new panels. (Institute of Technical Architects)

New generation glass. (Institute of Technical Architects)

Construction and sustainable development seminar. (Generalitat)
Solar Components and their integration in buildings. (Institute of Technical

Architects)

Projects and bidding competitions with integral sustainable environmental criteria (Energetic production, energy efficiency, waste management, water cycle, etc.):

Competition to the environmental museum of Lleida.2008
Competition for the integral protection planning of the Baronia de Escriche (Teruel), Provincial Council.

Competition for the Archaeological Museum of Cartagena, Ministry of Culture.

Competition for the Research Centre Building of the UPC Campus Castelldefels, University Commission.

Competition new technologies, INCASOL.

International Competition for the reconstruction of Sarajevo, UIA.

Competition for the Egyptian Museum in Cairo. Egyptian Government.

From the members of our team we highlight their research and complementary studies in environmentally related subjects:

Roser Amadó Cercós, architect. "MAUS" Masters degree in urban environment and sustainability from UPC. (1998)

LIFE studies program in the Escola Sert in the Institute of Architects (1998).

Lecturer at the Energetic Efficiency Techniques seminar. U.E.D.G. November 1997.Jury member for the product section of Construmat.

Ramón Domènech Girbau, Technical Architect. Lecturer *Historic Building Rehabilitation* Masters program, Institute of Technical architects of Barcelona (1994) Participant at the Energetic Efficiency Techniques seminar. U.E.D.G. November 1997.

Since September 2010, B01 architects is member of Green Building Council España, partner of BCG's global network, which drives through the tools LEED / BREEAM / GREEN, Green Building together with all those involved in construction.



Published projects

- *Qualità Urbana in Europa* [Urban Quality in Europe] Fiere Internazionale di Bologna, Italy, 1993. Dwellings in the historic centre of Lleida.
 - *Lleida. Nova activitat per un Centre Antic* [Lleida. New Activity for an Old Quarter] Lleida City Council, edited by Lluís Domènech. Dedicated to the ten-year development of the historic centre, 1991.
 - *Consagrado al desarrollo de 10 años del Centro Histórico* [Establish to the 10 year development of the Historical Centre]. Guide to Architecture in Spain (1929-1996) Carlos Flores, Xavier Güell.
 - *Arquitectura catalana en el mundo* [Catalan Architecture around the world] Generalitat de Catalunya, 1993.
 - *Nuevos Museos* [New museums] Josep M^a Montaner, 1990. Ed. GG.
 - *Zodiac 14* [Zodiac 14] issue on Palace of Justice, 1995.
 - Monograph *Documentos de Arquitectura* [Documents of Architecture], number 7, Almería, 1987.
 - *Quaderns*, special issue, *TRIPTIC* 207-209, 1995.
 - *La Arquitectura en Europa* [The architecture in Europe] A. Tzonis, Ediciones Destino, 1993.
 - *Registre d'Arquitectura Moderna a Catalunya* [Register of modern architecture in Catalonia] Department of Culture, Generalitat of Catalonia, Architects Association, 1996.
 - *Guía de Arquitectura. España 1920-2000*. [Architecture Guide] Tanais Ediciones, Ministry of Public Works, 1997.
 - *Europe. The Contemporary Architecture Guide. Vol. 1.* Masayuki Fuchigami, 1998.
- Exhibition of the last projects in *El Arte de los 80* [The Eighties Art] series in the Craftsman Civic Centre of Barcelona, 1986

Publications in magazines:

Casabella (Italy), *Quaderns* (Barcelona), *Arquitecturas-bis* (Barcelona), *Architectural Review* (England), *Lotus* (Italy), *Geometría* (Málaga), *La Architecture de Aujourd'hui* (France), *Moniteur Architecture* (France), *Casa Bogo* (Italy), *El Croquis* (Madrid), *Arquitectura Viva* (Madrid),

- Arquitectura* (Madrid), *A.V.* (Madrid), *Archis* (Holland), *UR* (Barcelona), *Detail* (Germany), *Diseño Interior* (Madrid), *A.D.* (England), *Nueva Forma* (Madrid), *Sierra de Oro* (Barcelona), *DONDE* (Madrid), *Section A.* (Montreal), *Ciudad y Territorio* (Madrid), *Rassegna de Architettura e Urbanistica* (Roma), *Architektur+Wettbewerb* (Stuttgart), *Archithese* (Zurich), *The Architects' journal* (London), *World* (BBC Magazine), *Cercha* (Madrid), *Wind* (Japan), *Barcelona Metròpolis Mediterrànea*, *Arquitectura Mediterraneenne* (France), *De Architect* (The Hague), *Building Design* (England).
- Collaboration in the guide *Descubrir Lleida* [Discover Lleida] Jaume Porta Casanellas, March editor, 2005.
 - *Vivienda Pública en Barcelona* [Public housing in Barcelona] PMH Publication Marina, 2005.
 - Report on the Cap Pont university building and Marina housing in the magazine *ConArquitectura*, 2005.
 - Publication of the Marina building, the magazine *Arhitectura*. Romania, September, 2006.
 - *Dos patios Mediterráneos. Ca l'Ardiaca y Palacio de los Virreyes* [Two mediterranean patios. Ardiaca House and Viceroy's Palace]. Editorial Gustavo Gili, 2006.
 - Publications of several work (Sabadell, Palau Lloctinent i Lleida) the magazine *Arquitectura Plus* Grupo Vía, 2006.
 - Magazine *Barcelona, metròpolis mediterrània*, report dedicated to the rehabilitation of the Viceroy's Palace, 2007.
 - *Vivienda asequible y calidad de vida en Barcelona (2004-2010)* [Affordable housing and life quality in Barcelona (2004-2010)] Barcelona Council, February 2007.
 - Collaboration in the book *Lluís Domènech i Montaner. Viajes por la Arquitectura Románica* [Travels in Romanesque architecture] La Caixa Foundation y MNAC, 2007
 - *D-Book*, A+T editors, Vitoria Gasteiz. Marina Housing
 - *Casernes de Sant Andreu* [Barracks of Sant Andreu]. Edit. Lunweg, 2009

Awards and Distinctions

International

Prix Européen de la reconstruction de la Ville" 1992. Mention for the Tàpies Foundation, Barcelona

Second prize, International Union of Architects competition, for the ZAL (Logistic Activity Zone) building, Prat de Llobregat, 1996.

Selection to the Dedalo Minosse Prize, Vicenza. Palau del Lloctinent, Barcelona

2nd Prize to the Bienal Miami+Beach 2009: Semàfor & Carrabiners.

National

Construmat Award 1985 for the "best residential building completed this year in Spain" for the dwellings in Carrer Rec Comtal, number 20, Barcelona.

National Urbanism Award 1985 for the Special Plan of the historic centre of Lleida.

Finalist, FAD Award 1982 for the dwellings in Carrer Jaume Càncer, number 17, Barcelona.

Winners of the bid called by the Ministry of Health, Generalitat of Catalonia, for the Central Health Laboratory building, Passeig Lluís Companys, Barcelona, 1983.

Selection of the Canyet neighbourhood, Lleida, for the I Biennale of Spanish Architecture, 1990.

Selection of the Escuela Cervantes, Lleida, for the II Biennale of Spanish Architecture, 1992.

National PAD Award, for the Palace of Justice building, Lleida, 1992.

Honourable mention made of the residential building in Girona for the VETECO-ASAFAVE Award, Madrid, 1998.

Selection of various projects made for the *Guía de arquitectura. España 1920-2000* [Architecture Guide: Spain. 1920-2000], Ministry of Development.

Mention for the Rehabilitation of the Archive of the Crown of Aragón, at the yearly Rehabilitation award of the Spanish Superior Architects Counsel.

Finalist on the Accesibility Prize to the DFA Foundation: Semàfor & Carrabiners. 2009

Regional

Winners of the bid called by the Barcelona City Council for the Carbueros Metálicos building, Carrer Aragó/Roger de Llúria, Barcelona. 1990.

Finalists, FAD Award, for the Fundació Tàpies building, Barcelona, 1990.

Winners of the restricted tender for the Honda offices and warehouses on the A-7 motorway, Santa Perpètua de la Mogoda, 1992.

Finalists, FAD Award, for the gate/building in the Villa Olímpica, Barcelona, 1993.

Selection of the Archive of the Crown of Aragon building for the MOPU (Ministry of Public Works) Spanish Architecture Exhibition, 1992-93.

National PAD Award for the Carbueros Metálicos headquarters, Barcelona, 1994.

Selection made of the Carbueros Metálicos headquarters, Barcelona, for the III Biennale of Spanish Architecture.

Finalist, Bonaplata Award 1993, for the Honda headquarters.

Finalist for the San Benito de Alcántara Award for engineering, 1988.

Final selection of the residential building in Girona for the Girona College of Architects Award, 1977.

Winner of the First Década Award, 2000, for the Fundació Tàpies building.

First Prize for 156 Dwellings for Young People, Barcelona, PMH.

Finalist, City of Badalona Architecture Award, 1999-2000.

Mention Década Award, 2001, for the Vil.la Olímpica Gate Building

Honorable mention New Technologies Competition Incasol

Mention Década Award, 2004, for the Carbueros Headquarters

SPECIALIZED PROJECTS AND/OR COMPETITIONS



Rehabilitation of Lleida History City Centre

Site: Lleida
Client: Generalitat de Catalunya; Lleida Council; Incasol
Year of the project: 1982-1997
Construction: 1983-2001
Area: 10.000 m²
Awards: National Urbanism Award 1985 (Planning) Nominated for San Pedro de Alcántara Award (Wall and elevator). Selected for the Spanish Biennial 1992

The creation of a slurry wall allows to turn a "urban vacuum" into a urbanly useful area in the Canyeret Quarter.



Paseo Picasso Street. Ciutadella Park

Site: Barcelona
Client: Barcelona Council
Year of the project: 1981
Construction: 1983

The study includes the rehabilitation of the Fontseré Arcades, the urbanization in two stripes, road and pedestrian, of the street and the opening of a new access to the Park.



Accessibility to the historical Centre

Site: Vigo
Client: Concello Casco Vello
Year of the project: 2008
Difference in height: 56 m

Mobility and accessibility are the main aspects, pacifying road areas whereas promoting pedestrian access.

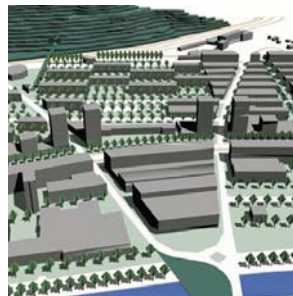

Restoration of Sarajevo centre (competition)

Site: Sarajevo. Bosnia
Client: Government of Sarajevo-UIA
Year of the project: 2000
Area: 50 Ha

Sustainability, accessibility and fusion of races compose the work hypothesis in the reconstruction towards an opened and multiracial city.



Baronía de Escriche (competition)

Site: Teruel
Client: Teruel Council.
Year of the project: 2002
Area: 500 Ha
Award: Second award

The superposition of models in different scales leads to a development of design which values territorial, landscape, space and cultural aspects.



Quaderns Competition for 400.000 dwellings (competition)

Site: Amposta
Client: COAC
Year of the project: 2007
Area: 7.000 m² and 2,5Ha

Facing up a large number of dwellings demonstrate the necessity of favoring compacity, complexity, efficiency and integration.

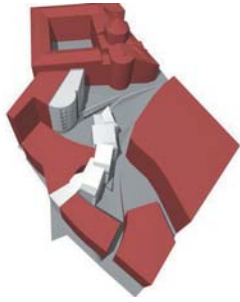

28 dwellings and underground parking "El Roser"

Site: C/ Caldereries. Lleida
Client: Incasol
Year of the project: 1997
Construction: 2001
Area: 5000 m²
Building Cost: 2.588 € (thousand)

The intervention develops a dwelling replacement program and the improvement of the public area.



153 Apartments for young people

Site: Marina street. Barcelona
Client: Patronato Municipal Vivienda
Year of project: 2001
Construction: 2004
Area: 12.000 m²
Building Cost: 4.925 € (thousand)
Awards: Winner of competition

The complex distribution enables a good relation with Marina Street and the typological study of the unit and the intermediate spaces.



60 rental dwellings in Pardinyes

Site: Pardinyes (Lleida)
Client: Incasol
Year of the project: 2002
Construction: 2005
Area: 6.450 m²
Building Cost: 3.097 € (thousand)

Both blocks respect the alignment with the main street and the side walls are superimposed to the secondary street; so that the block moves back in order to enlarge the green space.



53 dwellings for the Old Age

Site: C/ Viladomat (Barcelona)
Client: ProEixample
Year of the project: 2006
Construction: in progress
Area: 4.869 m²
Building Cost: 2.424 € (thousand)

The building has a compact character and an effectively use aim but, at the same time, tries to create a communal area for interaction.

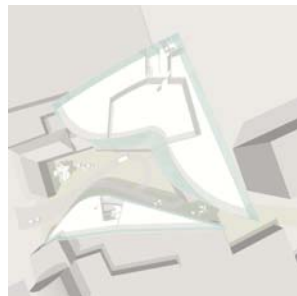

Apartment and Les Maximus square (competition)

Site: Heerlen, Holanda
Client: Heerlen Council, TCN Property and Smeets Beheer
Year of the project: 2007
Area: 3.000 m²

The building is divided into two volumes with different height for achieving the connection between the square and the park.

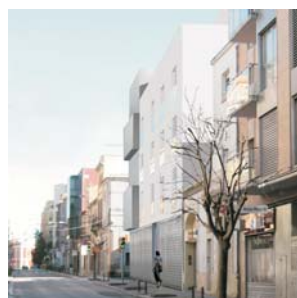

Residence for the Old Age (competition)

Site: Vilafranca del Penedés
Client: Vilafranca Council
Year of the project: 2008
Area: 4.300 m²

New proposal of residence where it is promoted the sociological concept of integration of the building with the city.



Tower-block of 28 dwellings

Site: Santa Eugenia Road. Girona
Client: Torregirona, S.A.
Year of the project: 1995
Construction: 1997
Area: 6.760 m²
Awards: Institute of Architects of Girona

An elliptical plan enables to integrate the impact of the railway with the Central Park and the classic Ensanche.



Multifunctional building

Site: Av. Carrilet (Hospitalet de Llobregat)
Client: Promo Ramble S.A.
Year of the project: 1996
Construction: 1997
Area: 13.285 m²
Building Cost: 3.222 € (thousand)

It is expected to provide continuity to the boulevard with a squared tower which is progressively stepped for giving the proper scale to the pedestrian.



112 Dwellings block

Site: Montigalà (Badalona)
Client: Urbis S.A.
Year of the project: 1997
Construction: 1999
Area: 13.500 m²
Award: Ciudad de Badalona

The efforts are focused on the creation of a interior patio for the block which relates the complex with the adjoining square and mitigates the dehumanized exterior



240 dwellings block in La Maquinista

Site: c/ Lima (Barcelona)
Client: Inmobiliaria Colonial S.A.
Year of the project: 1999
Construction: 2003
Area: 30.000 m²
Building Cost: 16.000 € (thousand)

The long urban facade makes clear the different typological episodes which are ended in a vertex with a singular volumetric solution.

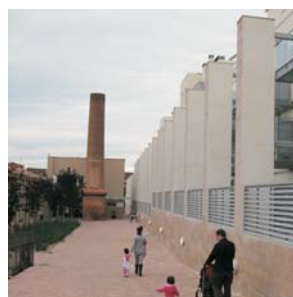

Vapores: Gran and Buxeda Nou

Site: Sabadell (Barcelona)
Client: Inmobiliaria Colonial S.A and Salas Associats
Year of the project: 2003-2004
Construction: 2007-2008
Area: 26.576 m²
Nº dwellings: 275
Building Cost: 22.430 € (thousand)

The street alignments, the preservation of the chimneys and the formulation of opened spaces determine the built units.



Residence for the UPC

Site: Passeig dels Til·lers
Client: RESA
Year of the project: 2000
Construction: 2002
Area: 3000 m²
Building Cost: 3.150 € (thousand)

A student residence and an office building articulated make possible to resolve a plot marked by its slope and the relation with the Deanship.



New building for the Archive of the Crown of Aragón

Site: Barcelona
Client: Ministry of Culture
Year of the project: 1989
Construction: 1993
Area: 6.500 m²
Building Cost: 3.900.000 €

The morphological, volumetric and topographic suggestions are used for emphasize the mediator character of the building.



Cap Pont 3. University Building

Site: Lleida
Client: University and Research Commissioner. Catalunya Government.
Year of the proj.: 1998
Construction.: 2000
Area: 7.860 m²
Building Cost: 4.200.000 €
Awards: First Prize Competition. Presented in the Venetian Biennale '04

The building is configured as the "alter ego" of its adjoining ones with a curve form which enables to face South and concentrate the communications.

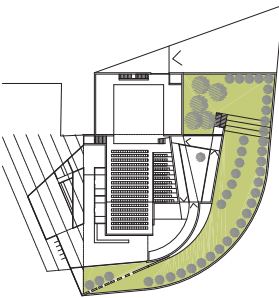

Theatre in Sant Andreu de la Barca

Site: Sant Andreu de la Barca (Barcelona)
Client: Barcelona Council
Year of the project: 2004
Construction: 2010
Area: 2480 m²
Building Cost: 2.900.000 €
Awards: First Prize Competition

The extension of Garcia Lorca Square originates an space which integrates the project with the market and reinforces its condition of opened and public building.



Theatre in Lloret de Mar

Site: Av. de Tossa, Lloret de Mar (Barcelona)
Client: Lloret de Mar City Council
Year of the project: 2006
Construction: 2011
Area: 2.760 m²
Building Cost: 4.521.700 €
Awards: First Prize Competition

Proposal of an idea of a pure and abstract box, a container dialoguing with the surrounding nature through its geometry and completion.



The Great Egyptian Museum (competition)

Site: El Cairo, Egipte.
Client: Egypt Government
Year of the project: 2002
Area: 60.000 m²

The museum structure is an hipertextual matrix which will make possible the superimposition of multiple paths and a great richness in meanings.



Extension of Vestsjaelland Museum (competition)

Site: Sorø (Dinamarca)
Client: Sorø Council
Year of the project: 2008
Area: 1.380 m²
Awards: Second position

A tree which invites the public to go inside, and then extends its branches to the garden encircling the patio and defining the exhibition areas.



Palace of Justice of Lleida

Site: El Canyeret (Lleida)
Client: Ministry of Justice
Year of the proj.: 1985 **Constr:** 1990
Area: 12.000 m²
Year of the extension: 2006
Constr.: in progress
Extension Area: 2.821 m²
Building Cost: 5.093 € and 5.500€ (thousand)
Awards: PAD Award

The Canyeret wall conditions the lineal proposal whose nature underlines the base role with regard to the Seo monument.



Gate/Building in the Olympic Vila

Site: Barcelona
Client: Eurocity S.A
Year of the project: 1989
Construction: 1989
Area: 3.360 m²
Building Cost: 2.424 € (thousand)
Awards: FAD Finalist Award
 Decada Finalist Award 2002

The building is presented as an autonomous architectural element which originates and space understood as a gate.



Montesa-Honda Headquarters

Site: Sta. Perpétua de la Mogoda
Client: Montesa-Honda
Year of the project: 1992
Construction: 1992
Enlargement: 2001
Area: 10.000 m²
Building Cost: 4.257 € (thousand)

The speed in the assembly and the versatility in the project use favor the rationalization of the growth in stages.



Carbueros Metálicos S.A. Headquarters

Site: Barcelona
Client: Carbueros Metálicos S.A.
Year of the project: 1990
Construction: 1994
Area: 11.524 m²
Building Cost: 4.800 € (thousand)
Awards: PAD finalist award
 Decada Finalist award 2004

The complexity of the different kind of urban plannings favours a display of prisms that turns and adaptes to the urban sequence.



LEITAT Technological Centre

Site: Terrassa
Client: Leitat
Year of the project: 2007
Construction: 2010
Area: 8.535 m²
Building Cost: 13.010 €

A large "aircraft carrier" sited over a former school in a pine sea, committing to guarantee flexibility in the programme and the application of sustainable criteria.



Public Building for the UPC

Site: Passeig dels Til·lers
Client: RESA
Year of the project: 2007
Construction: 2011
Area: 3.423 m²
Building Cost: 3.100 € (thousand)

The office building turns for getting volumetric and visual relation with the residence and looks for integration in the Deanship gardens.



Rehabilitation of a modernist building

Site : Canet de Mar.
Client: La Caixa de Pensions
Year of the project: 1980
Construction: 1982
Area: 300 m²

Replacing the fence of the modernist house for a bank building was the main purpose, which promoted two different aspects: the respect for the architectural singularity and the aim of conserving the garden character.



Restoration for the Tàpies Foundation

Site: Barcelona
Client: Barcelona City Council
Year of the project: 1986 **Construct.:** 1990
Area: 3.750 m²
Building cost: 4.200 € (thousand)
Awards: FAD Awards Finalist . Winner of Década's Award. Selected for the IX Bienal of architecture of Venecia 2004.
 BCIN 1997/1998

The effort is focused on making the contemporary nature of the project compatible with the respect for the Modernist building and the need of resolving the problem of the limited height.

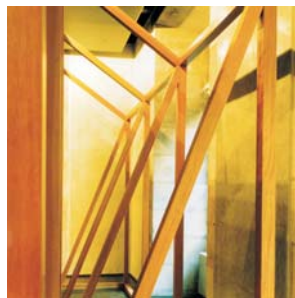

Hall of the Catalan Executive Council in the Govern of Catalunya

Site: Barcelona
Client: Barcelona Council
Year of the project: 1988
Construction: 1990
Area: 200 m²

Intervention in one of the halls of the Gothic Palace of the Catalan Government for standing a mural painted by Antoni Tàpies about the four books of the Catalan History Chronicles. In order to stress the mural a wooden stand is built and the hall is lighted by an artificial "sky".

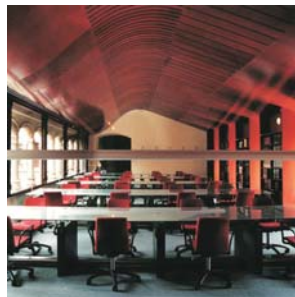
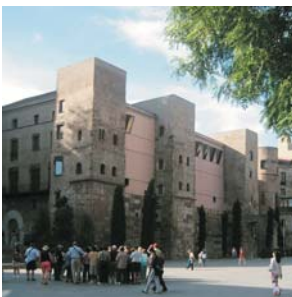

Remodelling of the Ardiaca House

Site: Barcelona
Client: Barcelona City Council
Year of the project: 1990
Construction: 1997
Area: 3.800 m²
Building cost: 4.200 € (thousand)
 BCIN 1924

The former Dean's house has been widely modified for creating different atmospheres along history. The project treats the building emphasizing the independence of the spaces and valuing their own unique nature. The reading room enjoys the best view over the Gothic District.



Restoration of the Viceroy's Palace

Site: Plaza del Rey.Barcelona
Client: Ministry of Culture
Year of the project: 1992-97
Construction: 2006
Area: 4.200 m²
Building cost: 6.269 € (thousand)
 BCIN 1931/1949

Typical case of restitution of a greatly damaged building which was compartmentalized in his original typology and morphology: redesign of the patio, chromatic treatment of the surface, stone rehabilitation and creation of flexible and harmonious areas.



Chic&Basic Hotel

Site: Amsterdam (Holanda)
Client: Chic & Basic
Year of the project: 2006
Construction: 2007
Area : 210 m²
Building cost: 300.000 €

Rehabilitation of an existing hotel enhancing its own characteristics and granting it a more contemporary vision by means of materials and new technologies.



Vichy Catalán Spa

Site: Caldes de Malavella (Girona)
Client: Vichy Catalan S.A.
Year of the project: 2004 / 2007
Construction: 2005 / 2008
Area: 1.232 m²
Building Cost: 2.097 € (thousand)

The project has the objective of progressively improving the building with the aim of restoring its initial quality. Different interventions have been made: Spa&Wellness, Restaurant, Cafe and Rooms Area.



Intervention in the Marshes

Site: Prat de Llobregat
Client: Prat City Council
Year of the project: 2006
Area: 5 Ha. **Construction:** 2009
Building cost: 288.024 €
Awards: Selected for FAD Awards. Accessibility DFA Awards Finalist. Silver medal in the Miami Beach Biennial

Time passed by the former military facilities transforming them into evocative ruins which complement the deserted beach. A footbridge leads to the lookout for birds and dialogues with the neoclassical building.



La Ricarda Museum

Site: Prat del Llobregat
Client: AENA
Project: 2008
Area: 4.200 m²
Building Cost: 3.222 € (thousand)
Museology competition: 1st Prize

The use of the premises with metallic structure and wooden trusses of the former farm enables the creation of a museum and a Delta interpretation hall, including an auditorium and a restaurant with local foodstuffs.



Wine Museum (competition)

Site: Vilafranca del Penedès
Client: Museum of Vilafranca Foundation
Year of the project: 2003
Area: 9.500 m²
Awards: 3rd position

The alive organism of the Museum fills the urban "interstice", exhausting completely the area in plan and section of the block of Vilafranca's historic city centre.



Palais de Justice de Paris (competition)

Site: Sur le site de Tolbiac
Halle Freyssinet
Client: ZAC
Year of the project: 2006
Area: 100.000 m²

The conservation of the Freyssinet industrial building and the compactation of the new building in plan makes possible a minimum alteration of the natural land and marks a sustainable attitude.

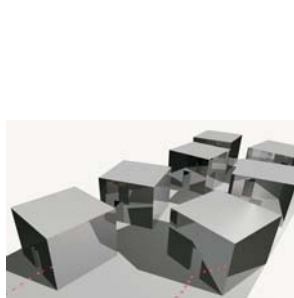

Llungües House (competition)

Site: Barcelona
Client: Barcelona City Council
Year of the project: 2007
Area: 4.933m²

The interaction of Can Ricart industrial buildings and the new designed areas develop a functional, compact and flexible structure.

The manner of building in Spain nowadays (2011) is tragically artisanal, inefficient, slow, poor-quality, costly and unsustainable. By industrialising the project, we opt for rational designs in which the standardisation of basic constructive elements produces an architecture that displays both modesty and quality. For B01, an integral vision that incorporates from the outset the criteria of structure, installations and architecture is the best way to achieve the necessary reductions on materials and energy, and consequently on economic costs, during both the construction and the life cycle of the building.

View video explaining the industrialized system: <http://www.b01arquitectes.com/eng/future/system>



Prefabricated "DOM" unifamiliar house

Site: Lleida
Client: Prefabricats M. Pujol
Year of the project: 2010
Area: 200 m²

DOM is a model of detached house built with industrialized components whose priorities are energy saving and the application of sustainable criteria.



Study or urban implementation of luxurious industrialized housing (I)

Client: Prefabricats M. Pujol
Year of the project: 2010
Area: 250 m² dwellings.

Study of the industrialized system in a real territory with the articulation of different typologies and its relation with the opened areas.



Study or urban implementation of luxurious industrialized housing (II)

Client: Prefabricats M. Pujol
Year of the project: 2010
Area: 450 m² dwellings.

Study of the industrialized system in a real territory with the articulation of different typologies and its relation with the opened areas.



Extension of the services area in Lleida - Alguaire Airport

Site: Lleida
Client: GISA
Year of the project: 2010
Area: 56.000 m²

The dialogue between both terminals is based on the volumetric composition and the use of the same language of colour stripes which reproduce the image of the countryside in the different seasons.



137 Apartments for social housing in Toledo

Site: Sta. María de Benquerencia.
Toledo
Client: EMV Toledo
Year of the project: 2011
Area: 19.428 m²
Units (net floor area):
2 Bedrooms dwelling (51.80m²)
3 Bedrooms dwelling (66.66m²)

Mixed solution of a block urban planning. Three facades align to the existing streets for facilitating the access and the fourth party wall is left opened to adapt to the new urban planning.



315 Social rental housing

Site: Alcobendas, Madrid
Client: EMV Alcobendas
Year of the project: 2011
Area: 36.114 m²
Units (net floor area):
 1 Bedroom dwelling (41.56m²)
 2 Bedrooms dwelling (55.67m²)
 3 Bedrooms dwelling (69.73m²)

The urban planning is proposed from double bay blocks parallel to the plot edges, difference in height in order to comply with the maximum height allowed by the planning and execution of a common area.



250 social housing units in "Nuestra Sra. de los Ángeles 12 y 13"

Site: Madrid
Client: EMVS Madrid
Year of the project: 2011
Area: 24.197 m²
Units (net floor area):
 1 Bedroom dwelling (40.60 m²)
 2 Bedrooms dwelling (54.35 m²)
 3 Bedrooms dwelling (68.06 m²)

The plot has a 5 meters difference in height on its limits, which allows to set back the block in its middle part and to place a parking floor in the access level.



Civic Centre and Dwellings for the old age. Camp Redó

Site: Polígono Camp Redó.
 Palma de Mallorca
Client: Consorci Riba
Year of the project: 2011
Area dwellings: 1.683 m²
Area Civic Centre: 658 m²
Units (net floor area):
 1 Bedroom dwelling (36.04 m²)

Restoration of Camp Redó area with the creation of new public buildings and green spaces in order to improve a degraded area.



Block for social housing with parking. Sant Joan Despí.

Site: Sant Joan Despí
Client: Aparcaments Despí S.A.
Year of the project: 2011
Area: 6.638 m²
Units (net floor area):
 33% 1 Bedroom dwelling (41.56m²)
 57% 2 Bedroom dwelling (55.68m²)

The block displays opened to the park and it is articulated for minimizing its hard effect, creating access to the nice front of Avenida de la Generalitat Street.

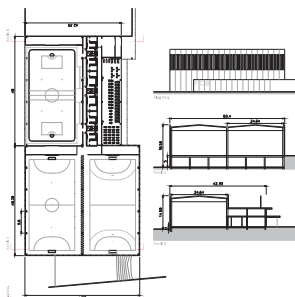

Proposal: Sports hall for three tracks in Joan Camper Centre

Site: Sant Feliu de Llobregat
Client: FC Barcelona
Year of the project: 2011
Area: 6.940 m²

Extension of the F.C.Barcelona Sport Centre with a three track sport hall for the indoor soccer, hockey and handball sections. The building maintains the principles of the existing construction.



Building for the University Research Institute

Site: Badajoz
Client: Badajoz University
Year of the project: 2011
Area: 8.260 m²

The container is displayed in two connected parallelepipeds orientated in North-South direction. With the application of the industrialized system a quick execution and a economic adjustment can be achieved.